

|        |                    |
|--------|--------------------|
| Length | 150mm<br>(6")      |
| Width  | 95mm<br>(3 3/4")   |
| Height | 90mm<br>(3 1/2")   |
| Weight | 500g<br>(1lbs 4oz) |

## Operating Instructions

Thank you very much for choosing SLIK Clamp head 45. SLIK Corporation has designed your Clamp head 45 to be a sturdy, rugged, dependable product that will provide you with many years of satisfactory use.

Please take a few moments to read this operating instruction carefully before use so that you can take full advantage of your Clamp head's many fine features.

Retain this operating instruction in case you might want to refer back to it.

### ⚠ Caution

This caution icon refers to information pertaining to important safety procedures in preventing injuries, or damages which may occur as a result of mishandling this product.

### 🚫 Prohibition

This prohibited icon refers to information pertaining to prohibited contents. Please refer to instructions closely to avoid accidents.

J845

## Components

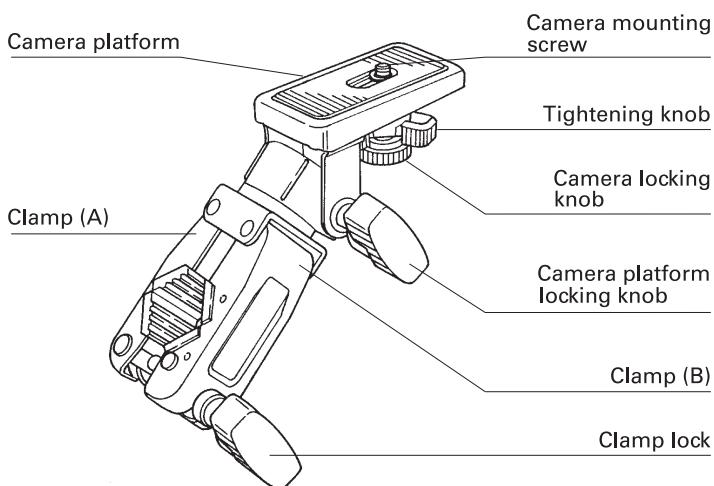

## Example of use

Using two cameras on one tripod.

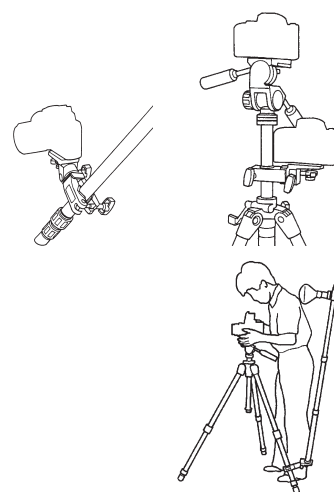

Use as a light boom with a SLIK S-pole Digital.

## Attaching to a tripod leg

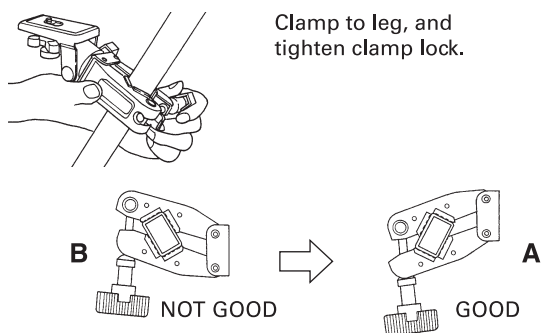

When attaching the clamp to a rectangular leg section, follow Figure A. Figure B shows the incorrect way to attach which can result in the clamp coming loose during tripod operation.

**Note:** Over tightening can cause damage to the legs.

Do not use with the carbon fiber pipe as it may be damaged.

## Attaching a camera

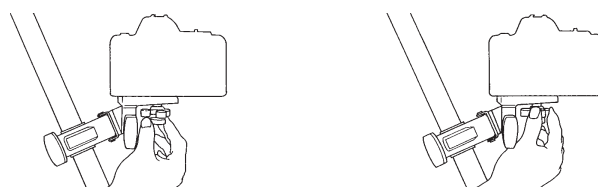

Hold camera and engage threads by turning the camera locking knob.

Tighten camera by turning the tightening knob.

## Care of the Tripod

- DO NOT apply any grease or oil to this product.
- Clean with a mild detergent and a soft cloth only.
- DO NOT use close to flame. Avoid extreme heat.

