

## How to get low position shots

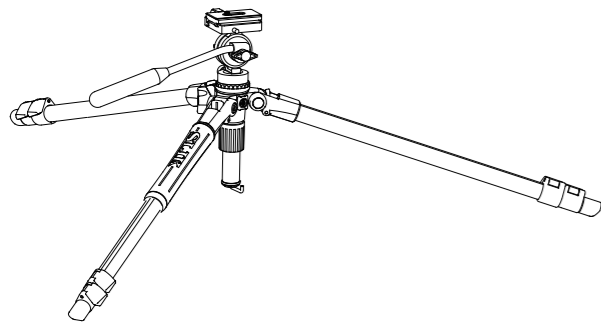

You can get lower height.

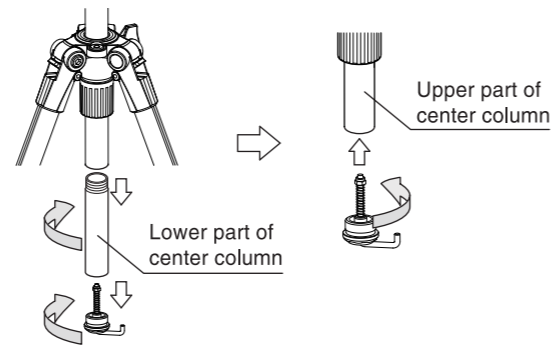

Remove the center column base stopper and then, remove the lower part of center column.  
Put the center column base stopper on the upper part of center column.

## Inverting the center column

### ⚠ Caution

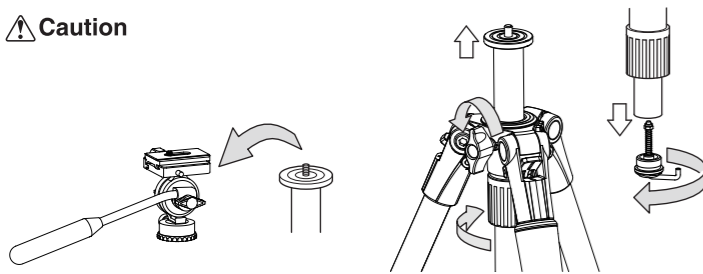

Remove the pan head when inverting or replacing the center column.

Remove the center column base stopper from the bottom of the center column.  
Loosen the center column locking nut and the center column stopper, and then pull out the center column.

### ⚠ Caution

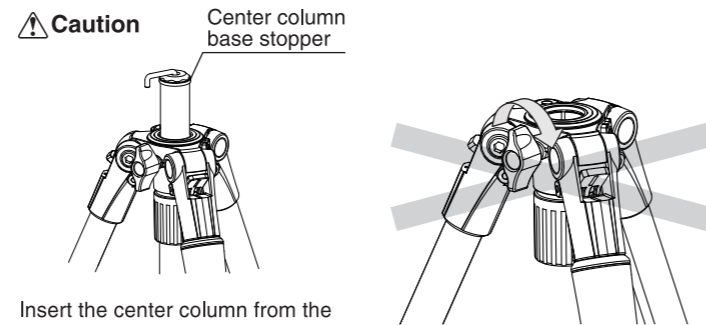

Insert the center column from the lower side of main body, and tighten the center column locking nut and the center column stopper. Make sure to re-attach the center column base stopper in order to prevent the center column falling out accidentally.

Please do not turn the center column stopper without a center column &/or an optional short center column. The internal parts may be damaged.

## How to change the panhead attachment screw

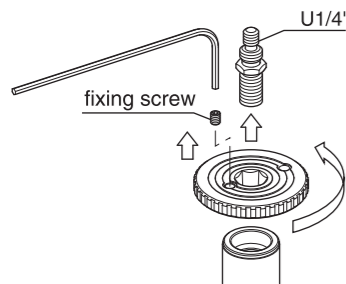

To change the U3/8" screw, loosen the fixing screw with an allen wrench (2.5mm width) and rotate the center column plate to remove from the center column. Then push out the panhead attachment screw from the bottom.

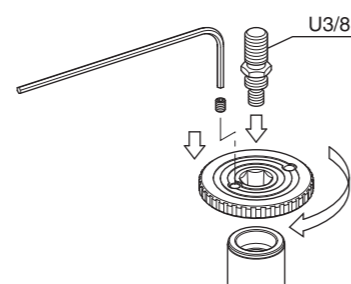

Flip the panhead attachment screw and put back to the center column plate. Screw in the center column plate and the panhead attachment screw. Tighten the fixing screw to avoid the rotating the center column plate while in use.

## Accessory connection thread

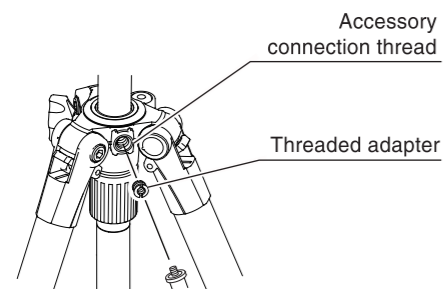

The tripod has 1/4" (if you take off the threaded adapter, 3/8") female thread which can be used to attach accessories, such as a light, a monitor, etc.

## Care of the tripod

- DO NOT apply any grease or oil to this product.
- Clean with a mild detergent and a soft cloth only.
- DO NOT use close to flame. Avoid extreme heat.

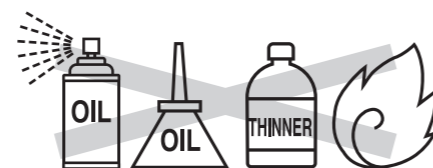

Slik Corporation reserves the right to make changes in design and/or improvements on the products without any obligation and advanced notice.

# SLIK®

## PRO AL-323 SVH

### Operating Instructions

Thank you very much for choosing SLIK product. The SLIK Corporation has designed your tripod to be a sturdy, rugged, dependable product that will provide you with many years of satisfactory use.

Please take a few moments to read this operating instruction carefully before use so that you can take full advantage of your Tripod's many fine features.

Retain this operating instruction in case you might want to refer back to it.

### ⚠ Caution

This caution icon refers to information pertaining to important safety procedures in preventing injuries, or damages which may occur as a result of mishandling this product.

### ⊘ Prohibition

This prohibited icon refers to information pertaining to prohibited contents. Please refer to instructions closely to avoid accidents.

T834-1

### Specification

Folded length	630mm (24.9 in)
Max. operating height	1,600mm (62.9 in)
Max. center column ext.	315mm (12.4 in)
Weight	1,850g (4.1 lbs)

With exclusive case

## Components

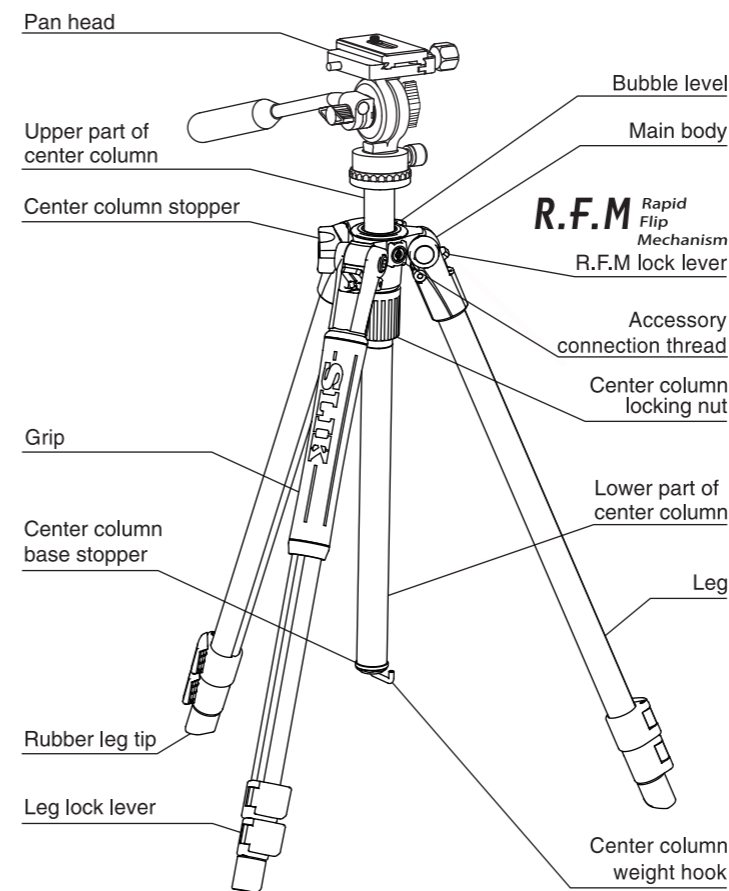

## Pan head

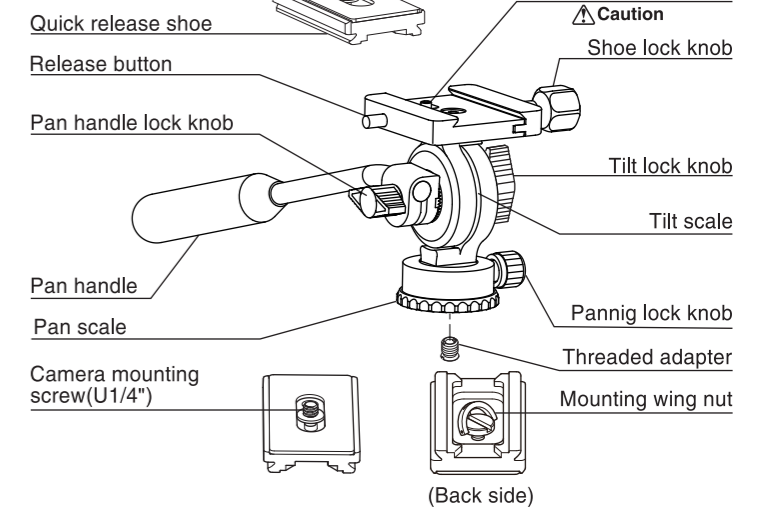

## Optional accessory

6502  
70mm length

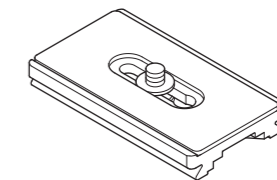

6503  
100mm length U1/4  
6263  
100mm length U3/8

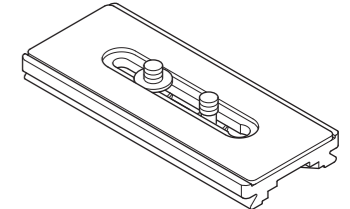

### ⚠ Caution

The unit can be fit with the Arca-Swiss compatible quick shoe other than the quick shoe that comes with it. However, the release stopper may be trapped depending on the shape of the quick shoe backside to be used. In this case, refer to the back side of this instruction and disable the release stopper function.

### ⚠ Caution

※Bubble level on the tripod is a rough criterion. It's not so accurate as a level on a camera.

## Equipment that can be loaded on this tripod

### ⊘ Prohibition

Maximum loading capacity : 4kgs (8.8 lbs)

This product has been designed to handle equipment weighing under 4kgs(8.8 lbs). Do not overload. Some equipments weighing under 4kgs(8.8 lbs), such as long lenses, may not balance well due to its weight distribution. In such case, please use a larger tripod.

## Carrying the tripod

### ⊘ Prohibition

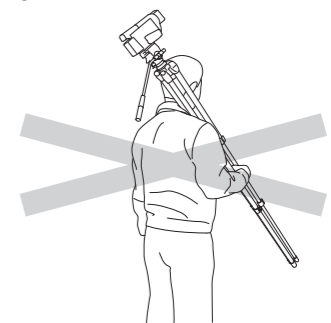

Carrying a tripod with a camera left on can result in unexpected accidents. We therefore, recommend you to remove your camera while carrying the tripod.

## Pan head mounting post

⊘ Prohibition

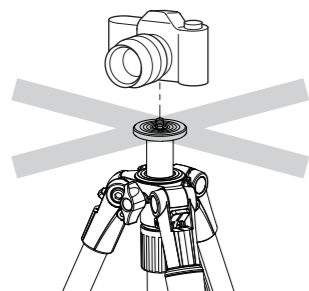

Do not attach camera directly to the threaded post of the center column. This may damage both camera and tripod.

## Setting up

⚠ Caution

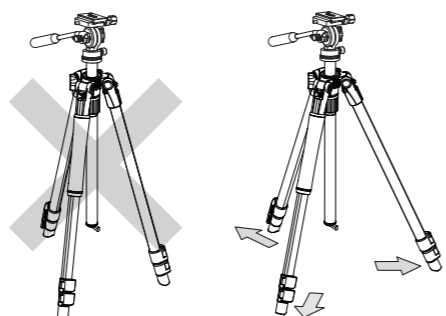

To prevent accidental equipment fall or tripod tipping over, making sure all levers, knobs and handles on the tripod are securely tightened, and all three legs are opened all the way.

## Removing head from the center column

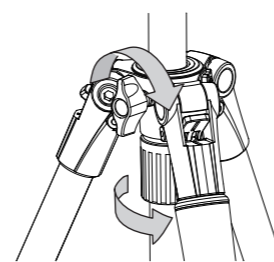

Tighten Center column stopper and Center column locking collar.

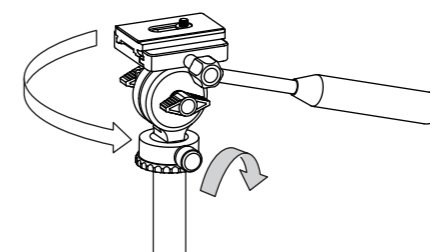

Lock the panning lock knob. Then grasp the pan handle and turn the head counter-clockwise to loosen.

## Setting the pan head to the center column

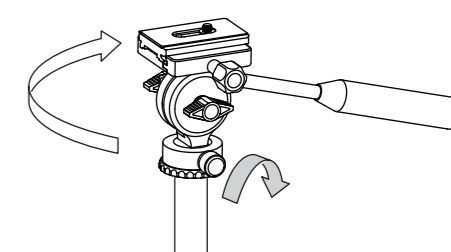

Set the pan head on the tripod's threaded post, and turn clockwise until it comes to a stop. Tighten the panning lock knob and turn clockwise slightly more.

## Remove the quick release shoe

⚠ Caution

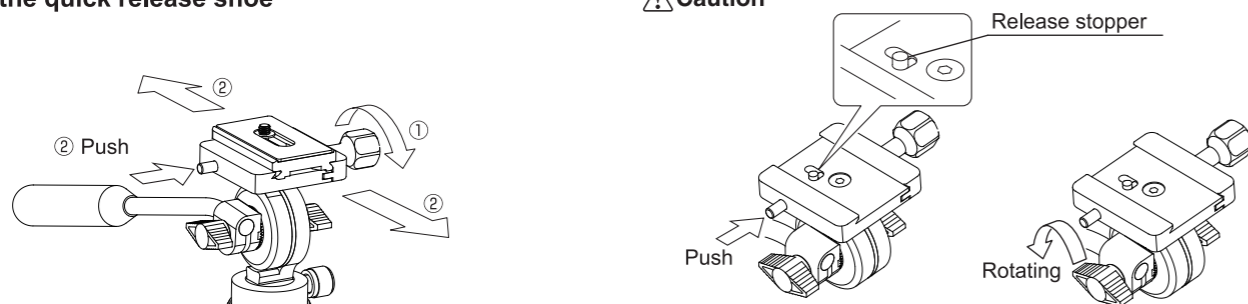

- Loosen the shoe lock lever about half a turn.
- While pressing the release button, slide the quick shoe in the direction of the arrow and remove the shoe plate.

It is possible to intentionally disable the release stopper function by pressing and rotating the release lever. The release stopper is retracted into the platform. It is convenient to use a third-party quick shoe and to remove equipment. However, the stopper function doesn't work, it can cause the equipment fall.

## R.F.M Three position adjustable legs

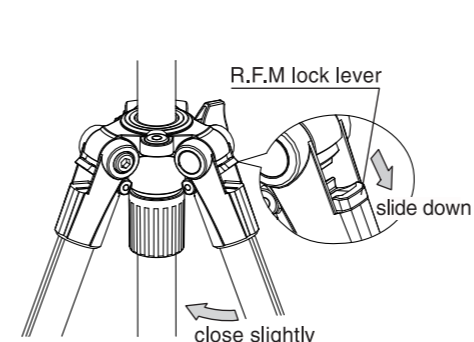

Close the leg slightly and slide the R.F.M lock lever down.

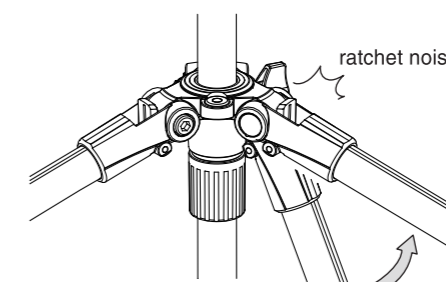

Move the leg up slowly, it will make a ratchet noise at a certain point. This position is the low position.

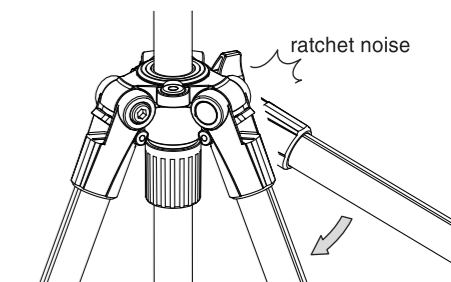

Close the leg further, a middle position or regular leg position can be chosen.

## Attaching a camera or telescope

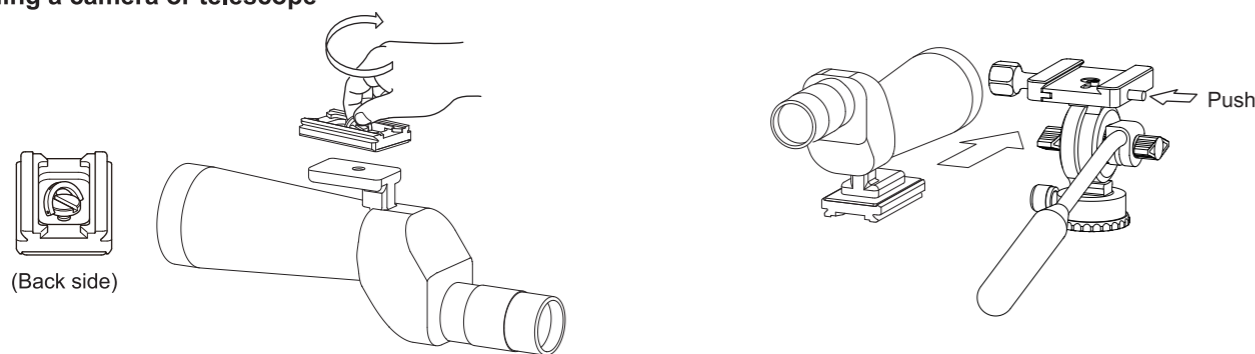

Attach the equipment screw hole and camera mounting screw and screwing lightly. Adjust the position of the quick shoe to the equipment and tighten the screw firmly. After installation, take down the mounting wing nut.

Press down the release button and insert the quick shoe into the camera platform. Tighten the shoe lock lever in the well-balanced position.

## Extending/Folding of tripod legs

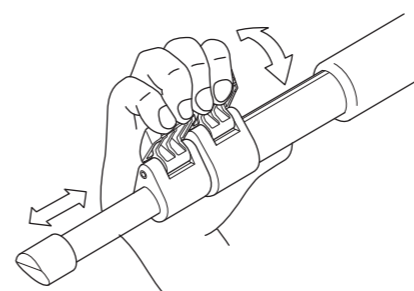

Flip up the leg lock lever to extend or shorten any of the individual leg sections to the desired length and press the leg lock lever flush against the leg to lock.



It is easier to extend the tripod logs if you turn the leg-tips to the foot, while leaving legs close.

## Operation

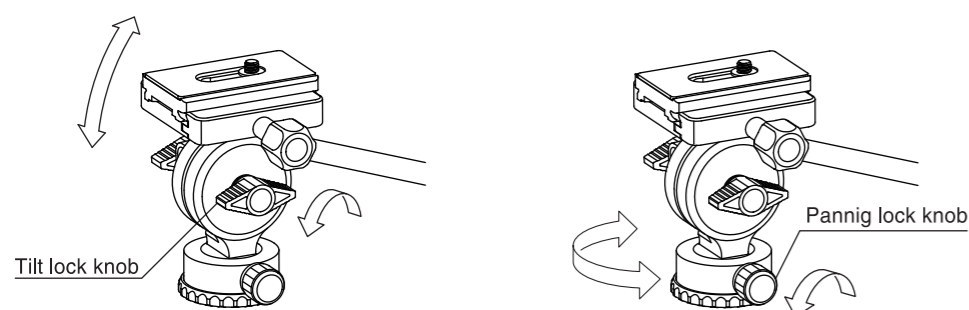

Loosen the tilt lock knob, and the head will tilt back and forth.

Loosen the panning lock knob, and the head will rotate along the horizontal direction.

⚠ Caution

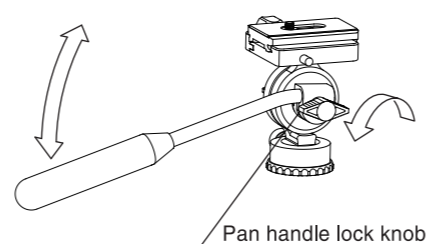

By loosen the pan handle lock knob, you can change the pan handle to the desired position. When adjusting the position of the pan handle, lock the tilt lock knob firmly. After you change the pan handle position, lock the pan handle lock knob firmly.

## How to use the center column

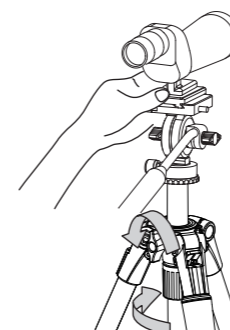

A - Screw-type  
Center column stopper is used to lock or unlock center column.  
B - Twist-type  
Center column locking nut is used to adjust a tension of the movement. The both of A and B must be locked for fixing center column.

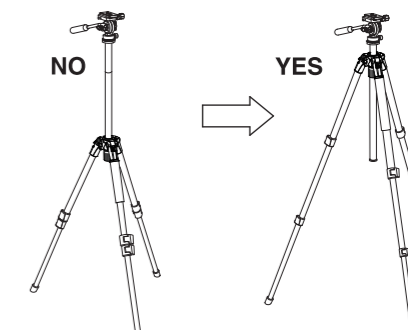

To avoid unnecessary camera vibrations, try to keep the center column height to a minimum. Also use the larger legs first when extending the legs.