

Balance adjustment (up & down)

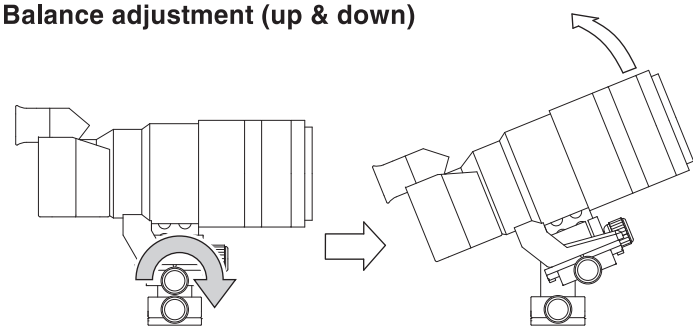

Caution

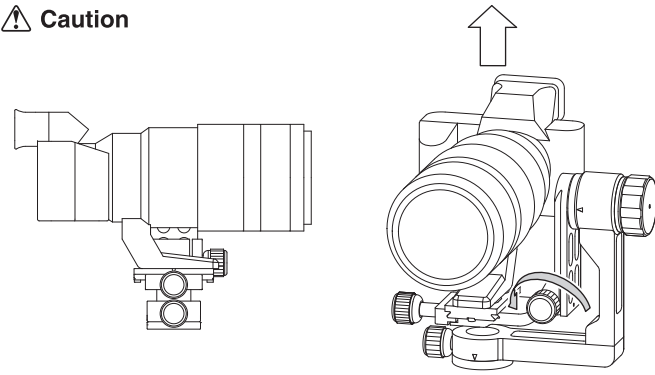

For the next step, adjust the camera height balance. Make sure shoe lock knob is securely fastened. Then, loosen the tilt lock knob and tilt the camera upwards.

If the camera faces horizontal when you release the hand from the camera, loosen the vertical lock knob while supporting camera and slide the camera upwards. Please make sure the camera platform wouldn't come off from the vertical plate.

Caution

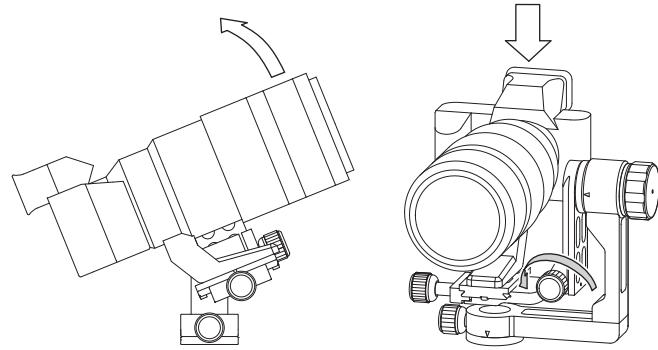

If the camera faces further upwards when you release the hand from the camera, loosen the vertical lock knob while supporting camera and slide the camera downwards. Please be careful not to pinch your fingers between the camera platform and the gimbal body.

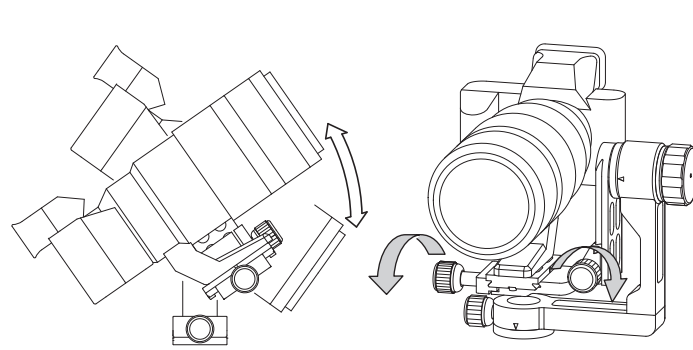

The position where the camera stays on the spot while tilting up and down, means camera is well balanced. Make sure once again, both shoe lock knob and vertical lock knob is securely tightened, before its operation.

Vertical shooting

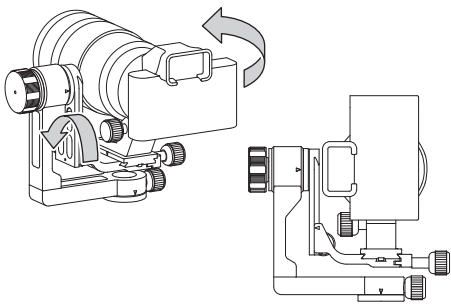

In case of vertical shooting, loosen the stopper knob on the tripod socket of the lens and rotate the lens 90 degree. For details of this operation, please refer to the instruction manual of the lens.

Prohibition

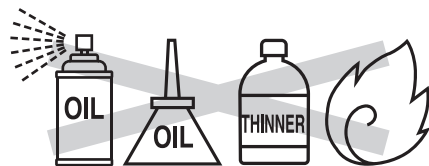

- DO NOT apply any grease or oil to the tripod or the head. It may cause product failure.
- If the movement of moving parts gets worse, please contact the dealer you purchased from or Slik Service Center.
- DO NOT use the unit close to flames or leave in a hot car for a long time.

Maintenance

- For cleaning the unit, use only a clean soft cloth with a mild detergent. Do not use organic solvents like paint thinner.

Slik Corporation reserves the right to make changes in design and/or improvements on the products without any obligation and advanced notice.

SLIK®

SGH-300

Operating Instructions

Thank you very much for choosing SLIK products. Please take a few moments to read these operating instructions carefully before use so that you can take full advantage of your tripod's many fine features. Retain this operating instruction sheet in case you might want to refer back to it.

Caution This caution icon refers to information pertaining to important safety procedure in preventing injuries, or damages which may occur as a result of mishandling this product.

Prohibition This prohibited icon refers to information pertaining to prohibited contents. Please refer to instruction closely to avoid accidents.

Specification

| | |
|--------|-----------------|
| Height | 160mm (6.3 in) |
| Weight | 800g (1.77 lbs) |

V191

Exclusive bag included

Components

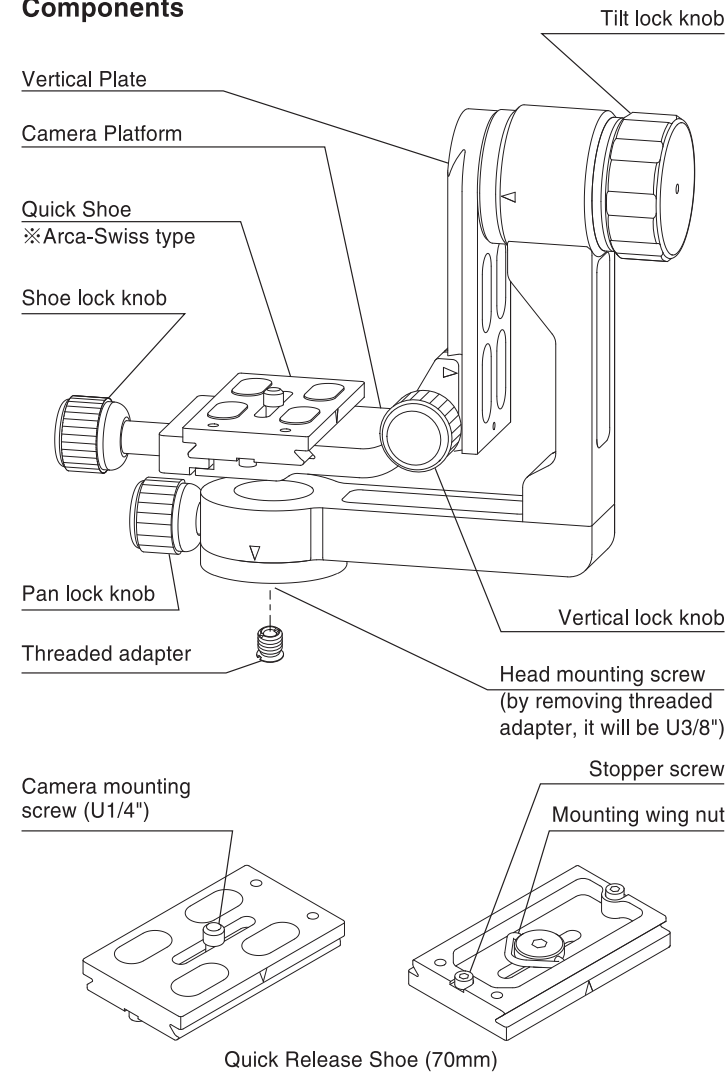

Equipment that can be loaded on this tripod

Prohibition

Maximum loading capacity : 3kgs (6.6 lbs)

This product has been designed to handle equipment weighting under 3kgs (6.6lbs). Do not overload. Even under its max. load capacity, some equipment such as long lenses, may not balance well due to its weight distribution.

Precautions for use

Caution

This product need to be balancing before using. Please take the balance adjustment correctly, to prevent accidental equipment clash, fall out or tripod tipping over. In addition, please do not leave away from the product while in use, so that you can always support the equipment.

Carrying the tripod

Prohibition

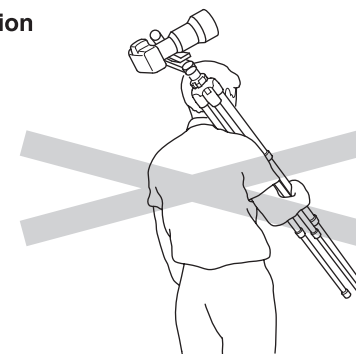

Remove camera from the unit while transporting. Camera may fall from the unit and cause bodily injury or property damage.

About Quick Shoe

Caution

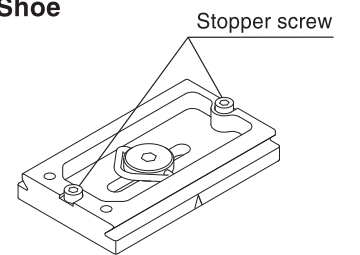

The unit can be fit with the Arca-Swiss compatible quick shoe other than the quick shoe that comes with it. However, the release stopper may be trapped depending on the shape of the quick shoe backside to be used. In case third party Arca-Swiss compatible quick shoe to be used, make sure camera will not come off from the stage while sliding the plate back and forth.

Setting up

⚠ Caution

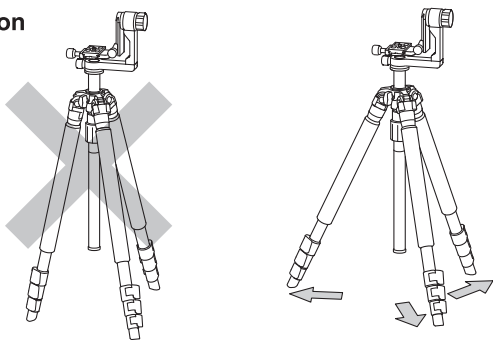

To prevent accidental equipment fall or tripod tipping over, making sure all levers, knobs and handles on the tripod are securely tightened. To avoid unnecessary camera vibration, spread all three legs opened all the way.

Set up the gimbal head

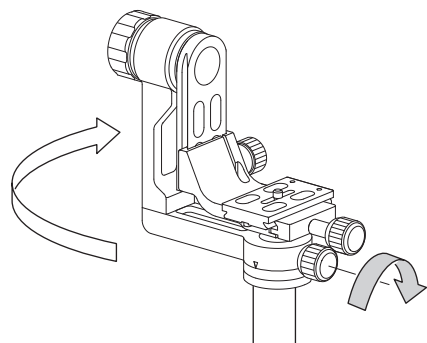

Set the gimbal head on the tripod's screw thread, and turn clockwise until it comes to a stop. Tighten the pan locking knob and turn clockwise slightly more.

How to use the gimbal head

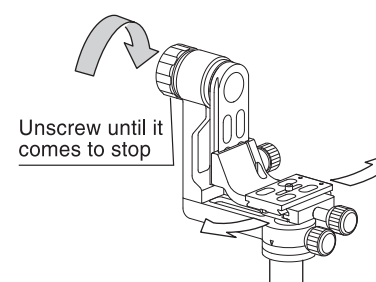

When tilt lock knob is loosen, the camera platform can be swang fore and aft. It isn't designed to obtain tilting friction by the tightening of the tilt knob. To fix the tilting angle, please tighten the tilt lock knob until it comes to stop. When locking the tilt lock knob, internal two rosette shaped parts will engage and lock the movement of the camera platform. Do not leave the tilt locking knob at the middle position. It will be the cause of rattle movement and wear of the parts.

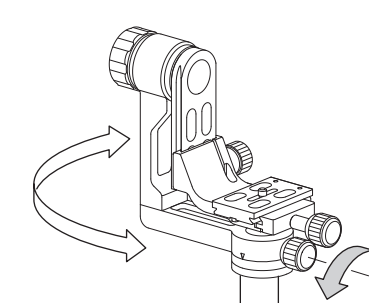
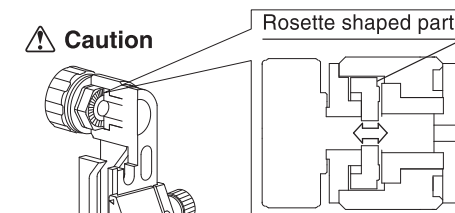

When loosening the pan locking knob, the gimbal head can be rotated horizontally. It isn't designed to obtain panning friction by the tightening of the pan locking knob. Before rotating the gimbal head, please make sure the pan locking knob is free.

Removing gimbal head from the tripod

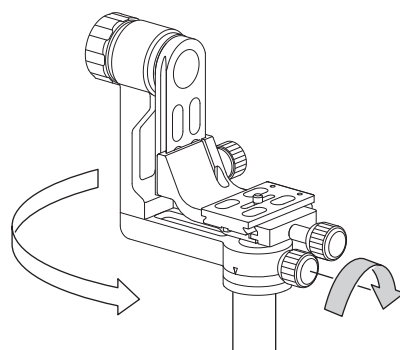

To remove gimbal head, tighten center column stopper. Lock the pan locking knob of the gimbal head. Then, grasp the gimbal head and turn the head counter-clockwise to loosen.

Remove the quick release shoe

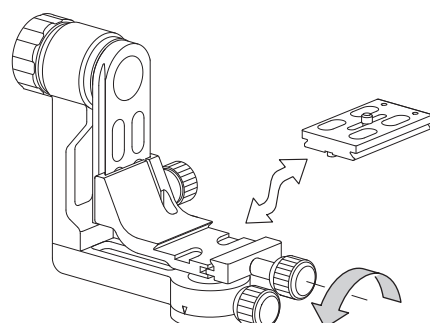

After loosening the shoe locking knob until its stop, the quick release shoe can be removed from the platform.

Balance adjustment (back & forth)

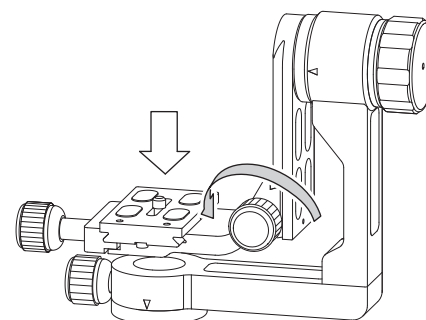

To balance the equipment, first to take the camera balance back and forth. Loosen vertical lock knob and bring the camera platform to the lowest position.

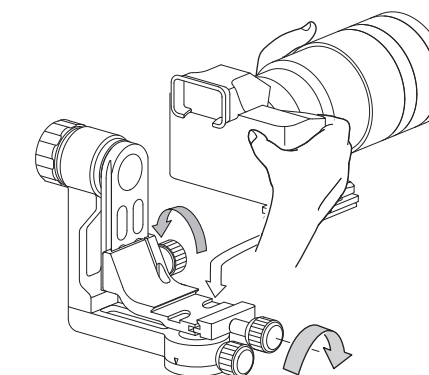

Tighten the vertical lock knob to fix the platform and mount the camera to the platform. Tighten the shoe lock knob to fix the camera to the platform.

Attaching a camera

⚠ Caution

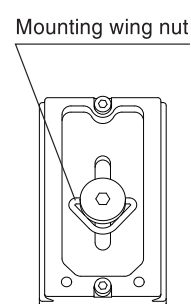
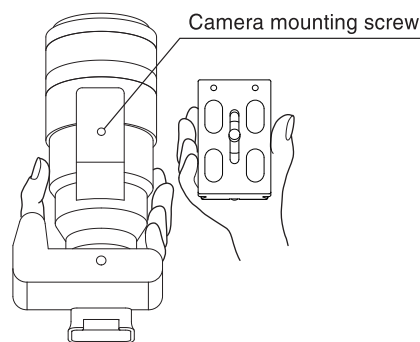

Attaching the camera mounting screw to the tripod socket hole of the lens and screwing lightly. Adjust the position of the quick shoe according to the lens and tighten the screw firmly. Do not attach the quick shoe to the camera side. You may not able to obtain proper balance or camera/lens may hit to the gimbal body while its tilting.

Loosen until it comes to stop

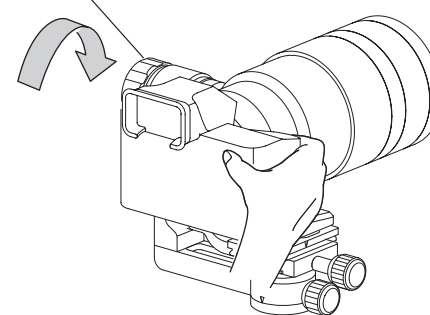

Hold the camera and loosen the tilt lock knob. Make sure to loosen the tilt lock knob until it comes to stop. Move the camera to the horizontal position and check how camera moves.

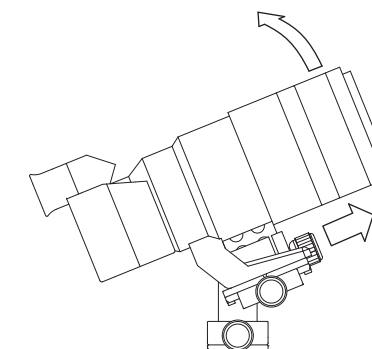

When camera face upwards, loosen the shoe lock knob and slide the quick release shoe to forward.

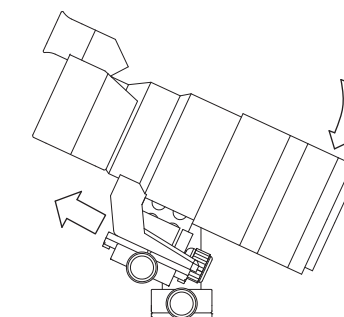

When camera face downwards, loosen the shoe lock knob and slide the quick release shoe to backwards.

⚠ Caution

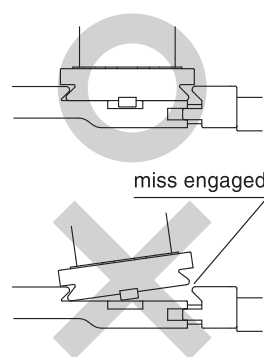
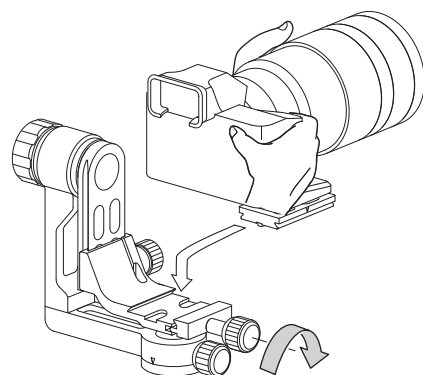

The camera/lens can be attached to the platform from top position. While attaching the camera to the gimbal body, please hold the camera/lens securely and make sure quick shoe is properly placed to the platform. Then, tighten the shoe lock knob until it comes to stop. If quick shoe isn't correctly mounted, the camera may fall off and it may cause injury or property damage.

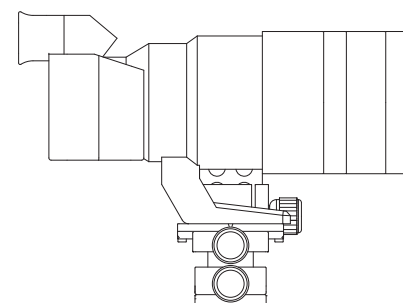

When you obtain correct back & forth camera balance, camera remain at horizontal position. If camera is too light, it may not tilt by itself. If so, tilt the camera back and forth, and adjust the position of the quick shoe so that the speed the camera will move back to horizontal is at the same speed.

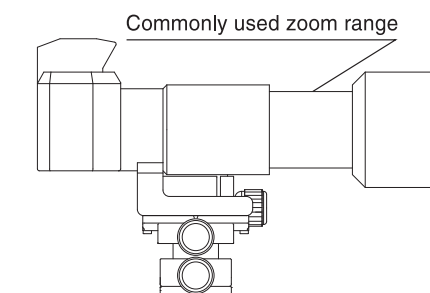

In the telephoto zoom lens where the front barrel is extended, the back and forth balance changes depending on the zoom position. Set the back and forth adjustment at commonly used zoom range.